

HONDA MAGNA 750 REAR AXLE BRACKETS INSTALLED

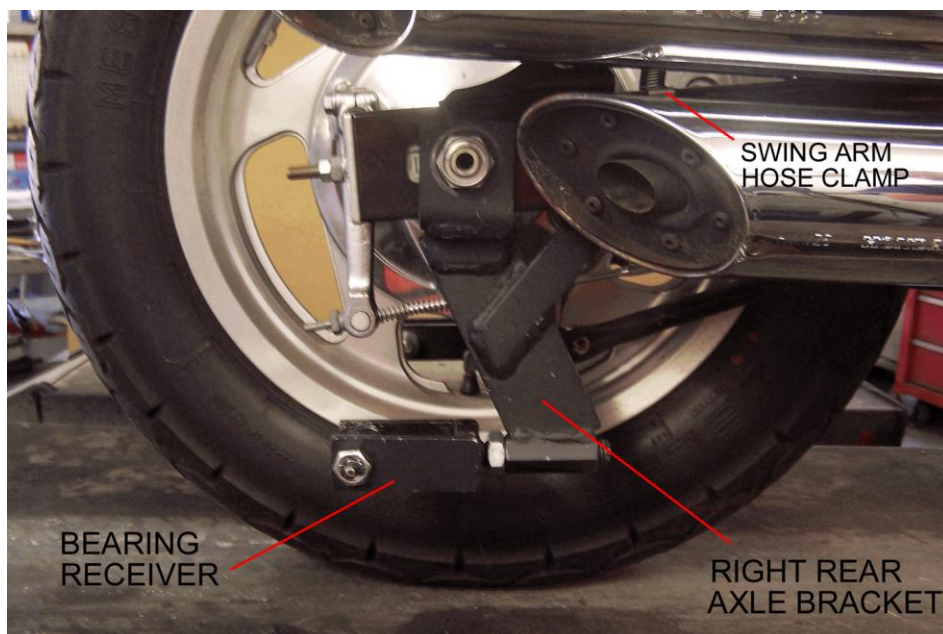

HONDA MAGNA 750 BELLY BRACKET INSTALLATION

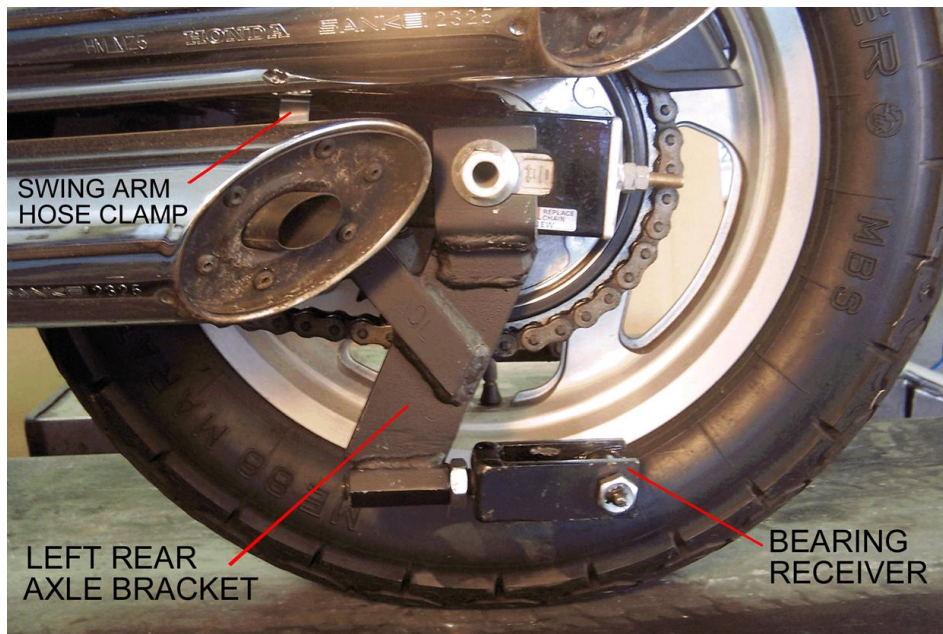
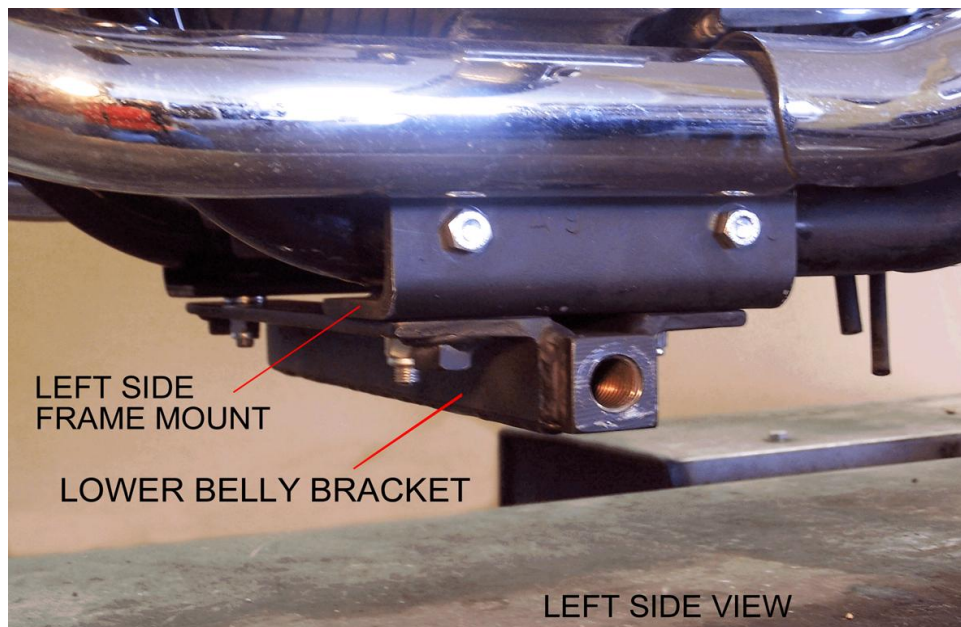
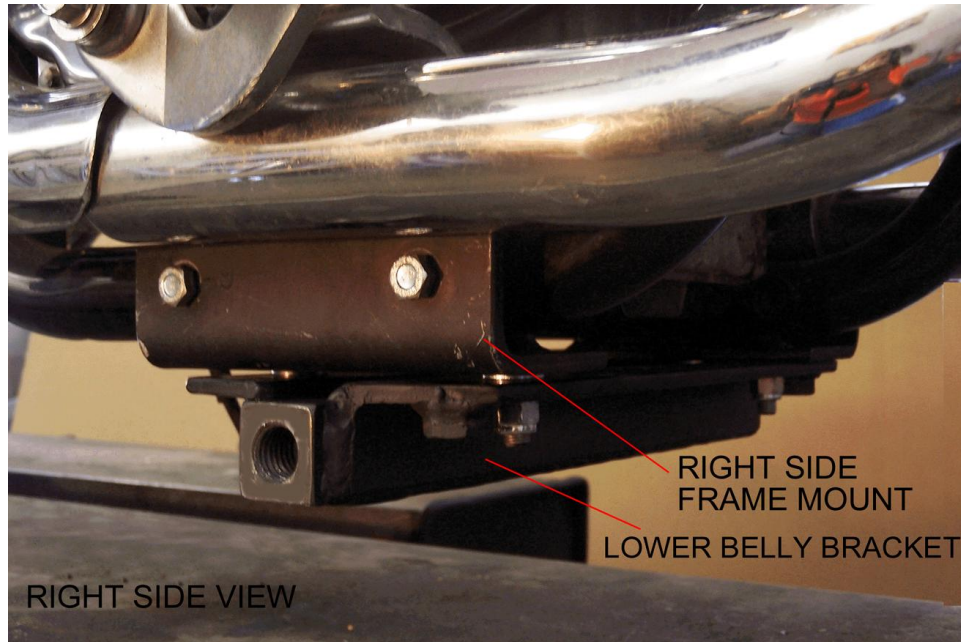

HONDA MAGNA 750

DESCRIPTION OF PARTS

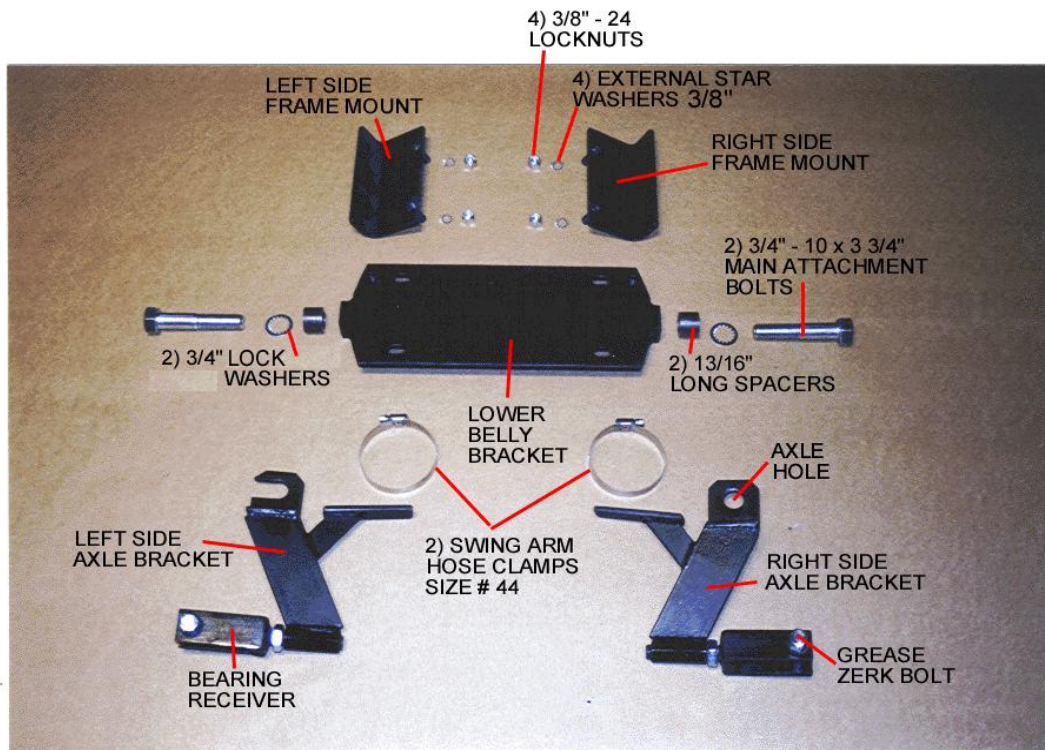

Two 3/8" washers used as shims– not shown in picture above.
 You may or may not have to use the shims. See note below.

After installing the mounting hardware and attaching the Voyager frame to the belly bracket you may need shims to make the motorcycle stand straight up and down. The shims may be used on either the left or the right side depending on which way the motorcycle is leaning. If the motorcycle is leaning to the left put the shims on the left side. If the motorcycle is leaning to the right put the shims on the right side.

**Install shims in-between
 frame mount and
 lower belly bracket.**

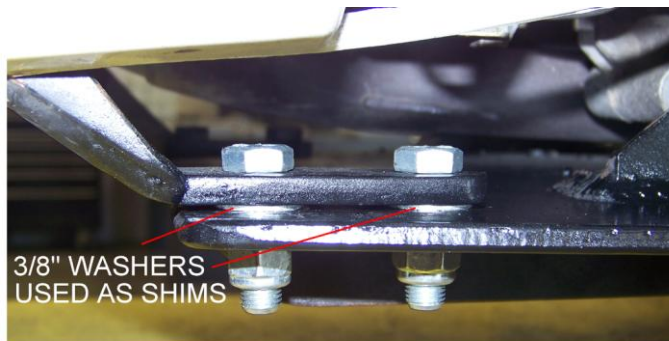

ILLUSTRATION OF SHIM PLACEMENT
 BRACKET PICTURED MAY NOT MATCH YOUR BRACKET

SECTION 1

INSTALLATION OF HONDA MAGNA 750

MOUNTING HARDWARE

Place motorcycle on a clean flat surface. Be sure to tie down motorcycle so it does not tip over during installation of Voyager hardware. Installation is easier if motorcycle is in an upright position.

Disconnect negative cable from battery before beginning installation.

NOTE: The Voyager Convertible Kit was designed for a stock motorcycle from the manufacturer. Any after market products that are on a stock motorcycle may cause the installation process to not be done properly and may or may not need to be removed to be able to install the Voyager Convertible Kit completely. Be aware that your motorcycle and the same make & model as someone else's motorcycle may not have mufflers, body panels, frames, fenders and any other manufacturer parts that are attached to the motorcycle in the exact same place as yours. We at Motorcycle Tour Conversion, Inc. take that into consideration when we manufacture our parts to fit your motorcycle. Once in awhile you may need to modify your motorcycle slightly so that the Motorcycle Tour Conversion, Inc. hardware or suspension fits your motorcycle. Please call Motorcycle Tour Conversion, Inc. if you have any questions about installation with after market products or any modification of motorcycle and/or Motorcycle Tour Conversion, Inc. hardware.

A) Belly Bracket Installation

- 1) Place motorcycle on a clean flat surface and stabilize in an upright position.
- 2) Remove four bolts (two bolts in each side) on the frame of the motorcycle.
(Bolts are located under foot pegs.)
- 3) Install Left Side and Right Side Frame Mounts on the frame using the four bolts that were removed. Tighten at this time.
- 4) Install Lower Belly Bracket to left and right side frame mounts. Make sure flat side goes toward frame mounts. Attach using nuts and washers supplied with kit.
Do Not Tighten at this time. Tighten after Voyager frame is aligned with motorcycle. Then tighten completely.

SECTION 1

INSTALLATION OF HONDA MAGNA 750

MOUNTING HARDWARE

B) Rear Bracket Installation

- 1) Loosen the rear axle bolt and remove the nut.
- 2) The slotted bracket goes on the left side. Tap the axle out approximately 1/4" and slide the left axle bracket onto the axle.
- 3) Next apply the swing arm clamp around the swing arm and the swing arm attachment and then tighten.
- 4) Place the right side axle bracket onto the axle and then replace and tighten the axle nut.
- 5) Next place the swing arm clamp around the swing arm and the swing arm attachment and then tighten.



MOTORCYCLE TOUR CONVERSION, INC.
1530 TITANIUM DRIVE
OTTAWA, IL 61350

TOLL FREE: 877-434-7901
FAX: 815-434-8980

HONDA MAGNA 750



INSTALLATION MANUAL
US PATENT # 6,739,420

**WARRANTY WILL BE VOID IF INSTALLATION
IS NOT DONE PROPERLY**

**READ THIS MANUAL FULLY BEFORE
BEGINNING INSTALLATION OR DRIVING YOUR
MOTORCYCLE WITH THE VOYAGER KIT ATTACHED**

